



# Tuscan Foundry Products LTD

## TRADE PRICE LIST



**HERITAGE RAINWATER  
& SOIL SYSTEMS**

**HERITAGE EXPRESS  
PUSH-FIT SOIL SYSTEM**

**STREET  
FURNITURE**

# WELCOME...

## CAST IRON SYSTEMS FOR RAINWATER, SOIL AND DRAIN

**TUSCAN**  
FOUNDRY PRODUCTS  
EST.1893

### TECHNICAL & SALES SUPPORT

#### TECHNICAL SERVICES:

INSTALLATION ADVICE

DESIGN ADVICE

DRAINAGE CALCULATIONS

CAD DRAWINGS

DATA SHEETS AND SPECIFICATIONS

#### SALES SERVICES:

CONTRACT MANAGEMENT

TAKE-OFF SERVICE

DIRECT TO SITE DELIVERIES

SAMPLES ON REQUEST

DEDICATED ACCOUNT MANAGER

### SITE VISITS AND SURVEYS ON REQUEST

Tuscan Foundry Drainage Ltd is one of the UK's leading manufacturers and distributors of Cast Iron products for the construction industry.

Our UK operations are based in Mid Wales. In addition to the industry leading range of traditional Cast Iron rainwater and soil goods we offer socketless, mechanically jointed Soil and Drain systems and a push fit above ground soil system.

As one of the few working foundries left in the UK we also offer a genuinely bespoke service that includes drawings, pattern making and manufacture.

The Tuscan Foundry Drainage Price List includes all our systems. Price Lists for individual systems, for instance Telford Drain, are available as downloadable PDFs from our website.

[www.tuscanfoundry.com](http://www.tuscanfoundry.com)

### CONTACTS:

SALES & GENERAL ENQUIRIES: 0333 987 4452

EMAIL: [info@tuscanfoundry.co.uk](mailto:info@tuscanfoundry.co.uk)

ACCOUNTS OFFICE: 0333 987 4452

TECHNICAL SUPPORT: 0333 987 4452

EMAIL: [info@tuscanfoundry.co.uk](mailto:info@tuscanfoundry.co.uk)

[www.tuscanfoundry.com](http://www.tuscanfoundry.com)





Tuscan Heritage LCC Soil is a traditional socket and spigot pipe system with fittings for above ground soil and waste. Most products are ex stock but other items are available as bespoke.

Heritage LCC Soil (BS469) is coated in a Bitumen paint. The main components of Bitumen paint are naphtha (petroleum) based.

In the past Bitumen was the main choice for traditional soil drainage due to its resistance to moisture and good coverage of uneven surfaces. **Normally this type of finish can't be over painted with other paint types, because not only will harder materials used for over coating tend to crack or craze, but there is also the possibility that the Bitumen will bleed through. We cannot, therefore, recommend overpainting as a viable option.** If the choice of colour is important, we recommend you see our Heritage Express range.

## LCC SOIL



SOIL PIPES & FITTINGS

71-74



<b>EARED PIPES</b>						
Premier (BS414)						
Description	50mm [2"]	65mm [2.5"]	75mm [3"]	90mm [3.5"]	100mm [4"]	150mm [6"]
1829mm [6FT] Eared	S2001E £137.00	S2501E £147.45	S3001E £147.45	S3501E £184.76	S4001E £184.76	S6001E £373.97
1219mm [4FT] Eared	S2004E £128.56	S2504E £140.35	S3004E £140.35	S3504E £172.59	S4004E £172.59	S6004E £332.79
914mm [3FT] Eared	S2003E £111.01	S2503E £119.41	S3003E £119.41	S3503E £149.36	S4003E £149.36	S6003E £310.57
610mm [2FT] Eared	S2002E £111.01	S2502E £119.41	S3002E £119.41	S3502E £149.36	S4002E £149.36	S6002E £310.57
1829mm [6FT] Double Socket Eared	S2001DE £181.62	S2501DE £189.40	S3001DE £189.40	S3501DE £247.29	S4001DE £247.29	S6001DE £509.12

<b>PLAIN PIPES</b>						
Premier (BS414)						
Description	50mm [2"]	65mm [2.5"]	75mm [3"]	90mm [3.5"]	100mm [4"]	150mm [6"]
1829mm [6FT] Plain	S2001 £129.70	S2501 £139.49	S3001 £139.49	S3501 £176.79	S4001 £176.79	S6001 £339.69
1219mm [4FT] Plain	S2004 £107.12	S2504 £114.35	S3004 £114.35	S3504 £141.53	S4004 £141.53	S6004 £296.27
914mm [3FT] Plain	S2003 £86.01	S2503 £91.69	S3003 £91.69	S3503 £113.29	S4003 £113.29	S6003 £267.94
610mm [2FT] Plain	S2002 £86.01	S2502 £91.69	S3002 £91.69	S3502 £113.29	S4002 £113.29	S6002 £267.94
1829mm [6FT] Double Socket Plain	S2001D £179.88	S2501D £185.35	S3001D £185.35	S3501D £220.72	S4001D £220.72	S6001D £441.01

<b>ACCESS PIPE</b>						
Premier (BS414)						
Description	50mm [2"]	65mm [2.5"]	75mm [3"]	90mm [3.5"]	100mm [4"]	150mm [6"]
Oval Door	S2010 £136.47	S2510 £136.47	S3010 £136.47	S3510 £148.93	S4010 £148.93	S6010 £241.66

<b>BENDS</b>						
Premier (BS414)						
Description	50mm [2"]	65mm [2.5"]	75mm [3"]	90mm [3.5"]	100mm [4"]	150mm [6"]
92.5°	S2020 £64.82	S2520 £78.45	S3020 £78.45	S3520 £96.34	S4020 £96.34	S6020 £161.03
112.5°	S2021 £64.82	S2521 £78.45	S3021 £78.45	S3521 £96.34	S4021 £96.34	S6021 £161.03
135°	S2022 £64.82	S2522 £78.45	S3022 £78.45	S3522 £96.34	S4022 £96.34	S6022 £161.03
with Door 92.5°	S2020D £160.52	S2520D £174.03	S3020D £174.03	S3520D £197.79	S4020D £197.79	S6020D £263.50
with Door 112.5°	S2021D £160.52	S2521D £174.03	S3021D £174.03	S3521D £197.79	S4021D £197.79	S6021D £263.50
with Door 135°	S2022D £160.52	S2522D £174.03	S3022D £174.03	S3522D £197.79	S4022D £197.79	S6022D £263.50

<b>EXPANDING PIECES</b>						
Premier (BS414)						
Description	50mm [2"]	65mm [2.5"]	75mm [3"]	90mm [3.5"]	100mm [4"]	150mm [6"]
75mm x 50mm [3" x 2"] Spigot Large End			S3052 £82.20			
100mm x 50mm [4" x 2"] Spigot Large End					S4052 £114.74	
100mm x 75mm [4" x 3"] Spigot Large End					S4053 £114.74	
150mm x 100mm [6" x 4"] Spigot Large End						S6052 £234.67

<b>DIMINISHING PIECES</b>						
Premier (BS414)						
Description	50mm [2"]	65mm [2.5"]	75mm [3"]	90mm [3.5"]	100mm [4"]	150mm [6"]
75mm x 65mm [3" x 2.5"] Spigot Small End			S3054 £114.74			
90mm x 65mm [3.5" x 2.5"] Spigot Small End				S3554 £141.46		
100mm x 90mm [4" x 3.5"] Spigot Small End					S4054 £141.46	

Ears can be fitted to any item on request – POA.



**LOOSE SOCKETS**

Premier (BS416)

Description	50mm [2"]	65mm [2.5"]	75mm [3"]	90mm [3.5"]	100mm [4"]	150mm [6"]
Eared	S2050E £40.78	S2550E £43.03	S3050E £43.03	S3550E £48.45	S4050E £48.45	S6050E £91.30
Plain	S2050 £36.35	S2550 £38.36	S3050 £38.36	S3550 £40.57	S4050 £40.57	S6050 £55.29

**OFFSETS**

Premier (BS416)

Description	50mm [2"]	65mm [2.5"]	75mm [3"]	90mm [3.5"]	100mm [4"]	150mm [6"]
75mm [3"] Projection	S2040 £86.26	S2540 £91.00	S3040 £91.00	S3540 £133.06	S4040 £133.06	S6040 £234.22
115mm [4.5"] Projection	S2041 £86.26	S2541 £91.00	S3041 £91.00	S3541 £133.06	S4041 £133.06	S6041 £234.22
150mm [6"] Projection	S2042 £86.26	S2542 £91.00	S3042 £91.00	S3542 £133.06	S4042 £133.06	S6042 £234.22
230mm [9"] Projection	S2043 £99.13	S2543 £104.58	S3043 £104.58	S3543 £147.64	S4043 £147.64	S6043 £267.60
305mm [12"] Projection	S2044 £111.00	S2544 £117.11	S3044 £117.11	S3544 £165.38	S4044 £165.38	S6044 £301.18
380mm [15"] Projection	S2045 £149.98	S2545 £158.23	S3045 £158.23	S3545 £240.79	S4045 £240.79	S6045 £381.93
457mm [18"] Projection	S2046 £179.74	S2546 £189.64	S3046 £189.64	S3546 £278.73	S4046 £278.73	S6046 £394.38
533mm [21"] Projection	S2047 £209.55	S2547 £221.07	S3047 £221.07	S3547 £334.49	S4047 £334.49	S6047 £407.43
610mm [24"] Projection	S2048 £231.29	S2548 £244.01	S3048 £244.01	S3548 £369.16	S4048 £369.16	S6048 £476.46

**EQUAL BRANCHES**

Premier (BS416)

Description	50mm [2"]	65mm [2.5"]	75mm [3"]	90mm [3.5"]	100mm [4"]	150mm [6"]
92.5°	S2030 £96.96	S2530 £105.09	S3030 £105.09	S3530 £154.70	S4030 £163.20	S6030 £267.31
112.5°	S2031 £96.96	S2531 £105.09	S3031 £105.09	S3531 £154.70	S4031 £163.20	S6031 £267.31
135°	S2032 £96.96	S2532 £105.09	S3032 £105.09	S3532 £154.70	S4032 £163.20	S6032 £267.31
92.5° with Door	S20300 £189.20	S25300 £197.35	S30300 £197.35	S35300 £233.71	S40300 £246.56	S60300 £362.93
112.5° with Door	S20310 £189.20	S25310 £197.35	S30310 £197.35	S35310 £233.71	S40310 £246.56	S60310 £362.93
135° with Door	S20320 £189.20	S25320 £197.35	S30320 £197.35	S35320 £233.71	S40320 £246.56	S60320 £362.93
92.5° Double	S2056 £198.67	S2556 £209.59	S3056 £209.59	S3556 £259.92	S4056 £274.23	S6056 £462.36
112.5° Double	S2056B £198.67	S2556B £209.59	S3056B £209.59	S3556B £259.92	S4056B £274.23	S6056B £462.36
135° Double	S2056C £198.67	S2556C £209.59	S3056C £209.59	S3556C £259.92	S4056C £274.23	S6056C £462.36

**UNEQUAL BRANCHES**

Premier (BS416)

Description	50mm [2"]	65mm [2.5"]	75mm [3"]	90mm [3.5"]	100mm [4"]	150mm [6"]
Unequal Available in 92.5°, 112.5°, or 135°		£89.07	£89.07	£126.76	£126.76	£126.76
Unequal with Door Available in 92.5°, 112.5°, or 135°		£167.24	£167.24	£208.96	£208.96	£307.57
Double Unequal Available in 92.5°, 112.5°, or 135°		£177.62	£177.62	£220.27	£232.40	£391.83



Due to the many possibilities in the Unequal Branches, please contact HF sales office for ordering codes. Ears can be fitted to any item on request - POA.  
Please check code for specific unequal branch.



<b>P TRAP</b>						
Premier [BSA14]						
Description	50mm [2"]	65mm [2.5"]	75mm [3"]	90mm [3.5"]	100mm [4"]	150mm [6"]
P Trap			S3096 £124.66	S3596 £151.36	S4096 £151.36	S6096 £355.90



<b>SHOES</b>						
Premier [BSA14]						
Description	50mm [2"]	65mm [2.5"]	75mm [3"]	90mm [3.5"]	100mm [4"]	150mm [6"]
Eared	S2051E £81.24	S2551E £85.71	S3051E £85.71	S3551E £112.20	S4051E £112.20	S6051E £229.35
Plain	S2051 £73.58	S2551 £77.61	S3051 £77.61	S3551 £104.62	S4051 £104.62	S6051 £193.25



<b>HOLDFAST</b>						
Premier [BSA14]						
Description	50mm [2"]	65mm [2.5"]	75mm [3"]	90mm [3.5"]	100mm [4"]	150mm [6"]
Holdfast	S2058 £8.50	S2558 £9.06	S3058 £9.06	S3558 £11.61	S4058 £11.61	S6058 £23.82



<b>HOLDERBATS</b>						
Premier [BSA14]						
Description	50mm [2"]	65mm [2.5"]	75mm [3"]	90mm [3.5"]	100mm [4"]	150mm [6"]
Screw to Wall [Hinged]	S2060 £53.04	S2560 £55.96	S3060 £55.96	S3560 £62.52	S4060 £62.52	S6060 £145.78
Steel Screw to Wall [Bolted]	S2064 £50.85	S2564 £55.96	S3064 £55.96	S3564 £62.52	S4064 £58.42	S6064 £145.78
Build-In	S2061 £45.34	S2561 £47.85	S3061 £47.85	S3561 £52.79	S4061 £52.79	



<b>BOSSSED PIPES</b>						
Premier [BSA14]						
Description	50mm [2"]	65mm [2.5"]	75mm [3"]	90mm [3.5"]	100mm [4"]	150mm [6"]
610mm [24"] Overall: 1.25"	S2081 £185.08				S4081 £203.15	
610mm [24"] Overall: 1.5"			S3082 £189.65		S4082 £203.15	
610mm [24"] Overall: 2"	S2083 £185.08		S3083 £189.65		S4083 £203.15	
Extra Boss					S4084 £53.44	



<b>STRAP ON BOSS</b>						
Premier [BSA14]						
Description	50mm [2"]	65mm [2.5"]	75mm [3"]	90mm [3.5"]	100mm [4"]	150mm [6"]
2" Bspt					S4092 £98.04	



<b>BLANK END</b>						
Premier [BSA14]						
Description	50mm [2"]	65mm [2.5"]	75mm [3"]	90mm [3.5"]	100mm [4"]	150mm [6"]
Blank End	S2070 £30.00	S2570 £31.67	S3070 £31.67	S3570 £39.73	S4070 £39.73	S6070 £79.46



<b>SOCKET REDUCERS</b>						
Premier [BSA14]						
Description	50mm [2"]	65mm [2.5"]	75mm [3"]	90mm [3.5"]	100mm [4"]	150mm [6"]
75mm x 50mm [3" x 2"]			S3086 £30.37			
100mm x 50mm [4" x 2"]					S4086 £39.73	
100mm x 75mm [4" x 3"]					S4087 £39.73	



<b>EARS</b>						
Premier [BSA14]						
Description	50mm [2"]	65mm [2.5"]	75mm [3"]	90mm [3.5"]	100mm [4"]	150mm [6"]
Loose Ears	S2065 £31.52	S2565 £33.24	S3065 £33.26	S3565 £38.05	S4065 £38.05	S6065 £49.03

Ears can be fitted to any item on request - POA.

**ORNAMENTAL EARBANDS**

Premier [BS416]

Description	50mm [2"]	65mm [2.5"]	75mm [3"]	90mm [3.5"]	100mm [4"]	150mm [6"]
Ornamental Type A	S20620A £123.17	S25620A £129.95	S30620A £129.95	S35620A £135.20	S40620A £135.20	S60620A
Ornamental Type B	S20620B £123.17	S25620B £129.95	S30620B £129.95	S35620B £135.20	S40620B £135.20	S60620B £168.55
Ornamental Type C	S20620C £123.17	S25620C £129.95	S30620C £129.95	S35620C £135.20	S40620C £135.20	S60620C £168.55
Ornamental Type D	S20620D £123.17	S25620D £129.95	S30620D £129.95	S35620D £135.20	S40620D £135.20	S60620D £168.55
Ornamental Type E	S20620E £123.17	S25620E £129.95	S30620E £129.95	S35620E £135.20	S40620E £135.20	S60620E £168.55
Ornamental Type F	S20620F £123.17	S25620F £129.95	S30620F £129.95	S35620F £135.20	S40620F £135.20	S60620F £168.55
Ornamental Type G	S20620G £123.17	S25620G £129.95	S30620G £129.95	S35620G £135.20	S40620G £135.20	S60620G £168.55
Ornamental Type J	S20620J £123.17	S25620J £129.95	S30620J £129.95	S35620J £135.20	S40620J £135.20	S60620J £168.55
Ornamental Type K	S20620K £123.17	S25620K £129.95	S30620K £129.95	S35620K £135.20	S40620K £135.20	S60620K £168.55

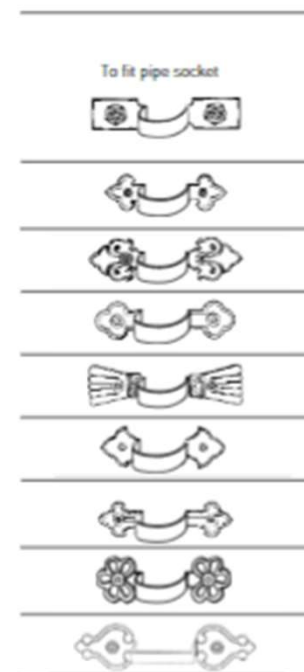





# LCC SOIL SUNDRIES





**LOOSE DOOR & GASKET****Premier [BS416]**

Description	50mm [2"]	65mm [2.5"]	75mm [3"]	90mm [3.5"]	100mm [4"]	150mm [6"]
Loose Door	S2069 £22.44	S2569 £24.00	S3069 £24.00	S3569 £26.14	S4069 £26.14	S6069 £40.94
Rubber Gasket	S2069G £6.98	S2569G £9.81	S3069G £9.81	S3569G £13.69	S4069G £13.69	S6069G £24.75

**COWL****Premier [BS416]**

Description	50mm [2"]	65mm [2.5"]	75mm [3"]	90mm [3.5"]	100mm [4"]	150mm [6"]
100mm [4"] To Fit Pipe Barrel					S4055 £77.00	

**WIRE BALLOON****Premier [BS416]**

Description	50mm [2"]	65mm [2.5"]	75mm [3"]	90mm [3.5"]	100mm [4"]	150mm [6"]
Wire Balloon	S2080 £14.80	S2580 £15.63	S3080 £15.63	S3580 £16.65	S4080 £16.65	S6080 £34.99

**WOODEN BOBBIN**

Description	
30mm Projection	R001 £2.63

**PIPE NAILS**

Description	
75mm [3"] to Suit all Pipe Sizes	R003 £0.89
100mm [4"] to Suit all Pipe Sizes	R004 £0.98

**SET SCREWS**

Description	
Per Pair [To Fit Loose Door]	S002 £3.69

**CAULKING CORD**

Description	
Per Metre – [Approximately 4m required for 4" Joint]	S006 £0.46

**JOINT SEALANT**

Description	
290ml Cartridge [Black] [1 required for approximately 4 Joints]	S007 £25.93



Installation instructions available on request.



**HERITAGE EXPRESS (HX)  
IS A PUSH FIT SOIL  
SYSTEM DESIGNED FOR A  
LIFETIME PERFORMANCE...**





Heritage Express (HX) is a push fit soil system designed for a lifetime performance. This contemporary Cast Iron system has the appearance of traditional Cast Iron soil drainage but requires no caulking or sealing. It is quicker to fit saving significant time on every joint. The sockets are manufactured to fit 50mm and 100mm pipes and fittings.

Pipes and fittings are manufactured in grey Cast Iron which exceeds the requirements of BS EN 1561 Grade EN JL 1020, ISO 185 Grade 15.

All push fit sockets are supplied with EPDM rubber sealing rings which are suitable for most applications. Where especially aggressive substances need to be discharged please check with our technical department as to their suitability.

# HERITAGE EXPRESS SOIL



## COATINGS

All pipes and fittings are factory coated with a two pack black gloss paint finish as standard, suitable for internal and external installations. All the pipes have an epoxy yellow internal coating. Heritage Express pipes and fittings can also be supplied in colours from the RAL range and also with our Coastal paint finish for marine environments.

Installation guidance is provided on instructions included with delivery and at [www.tuscanfoundry.com](http://www.tuscanfoundry.com)

## PIPES & SOCKETS, BENDS

79

## BRANCHES

80

## FITTINGS

81

## BRACKETS & SUNDRIES

82

**DOUBLE SPIGOT PIPES**

Product Code	Diameter [mm]	Length[m]	Price
TX2001	50	3	£149.37
TX2001A	50	1.5	£84.18
TX4001	100	3	£206.00
TX4001A	100	1.8	£123.64

**PUSH FIT SOCKETS**

Product Code	Diameter [mm]	Type	Price
TX2016	50	Plain	£40.77
TX2016E	50	Eared	£42.68
TX4016	100	Plain	£48.86
TX4016E	100	Eared	£52.52

**PUSH FIT SLIP SOCKET**

Product Code	Diameter [mm]	Type	Price
TX4016SE	100	Eared	£63.05

**DUCTILE IRON COUPLING**

Product Code	Diameter [mm]	Price
TX2012	50	£31.12
TX4012	100	£37.28

**SHORT RADIUS BENDS**

Product Code	Diameter [mm]	Angle	Price
TX2003	50	87.5°	£44.46
TX2005	50	45°	£44.46
TX4003M	100	87.5°	£64.69
TX4004M	100	67.5°	£64.69
TX4005M	100	45°	£64.69

**LONG RADIUS BENDS**

Product Code	Diameter [mm]	Angle	Price
TX4008	100	87.5°	£104.72
TX4009	100	22°	£104.72

**SHORT RADIUS BENDS WITH DOOR**

Product Code	Diameter [mm]	Angle	Price
TX4010M	100	87.5°	£133.87

**LONG RADIUS BENDS WITH DOOR**

Product Code	Diameter [mm]	Angle	Price
TX4011	100	87.5°	£177.01

**LONG TAIL BEND**

Product Code	Diameter [mm]	Angle	Price
TX4013	100	87.5°	£82.79



Supplied with gaskets



Supplied with gaskets

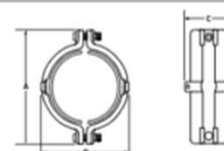

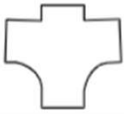

**SINGLE BRANCHES**

Product Code	Diameter (mm)	Angle	Price
TX2020	50	87.5°	£67.14
TX2026	50	45°	£67.14
TX4020	100 x 50	87.5°	£99.28
TX4025	100 x 100	67.5°	£99.28
TX4026	100 x 50	45°	£99.28
TX4028	100 x 100	45°	£99.28

**SINGLE RADIUS CURVE BRANCH**

Product Code	Diameter (mm)	Angle	Price
TX4030	100 x 100	87.5°	£99.28

**SINGLE RADIUS CURVE BRANCH WITH DOOR**

Product Code	Diameter (mm)	Angle	Price
TX4032	100 x 100	1.2	£169.77

**DOUBLE RADIUS CURVE BRANCH**

Product Code	Diameter (mm)	Angle	Price
TX4038	100 x 100	87.5°	£124.61

**SINGLE RADIUS CURVE BRANCH WITH 2" BSPT BOSS ON BACK**

Product Code	Diameter (mm)	Angle	Price
TX4039B	100 x 100	87.5°	£136.40

**SINGLE RADIUS CURVE BRANCH WITH 2" BSPT BOSS ON LEFT**

Product Code	Diameter (mm)	Angle	Price
TX4039L	100	87.5°	£136.40

**SINGLE RADIUS CURVE BRANCH WITH 2" BSPT BOSS ON RIGHT**

Product Code	Diameter (mm)	Angle	Price
TX4039R	100	87.5°	£136.40

**ACCESS PIPE WITH ROUND DOOR**

Product Code	Diameter (mm)	Price
TX2043	50	£105.21
TX4043	100	£117.83

**ACCESS PIPE WITH RECTANGULAR DOOR**

Product Code	Diameter (mm)	Price
TX4049	100	£181.99

**OFFSETS**

Product Code	Diameter (mm)	Projection (mm)	Price
TX4044	100	75	£68.43
TX4045	100	130	£91.21
TX4085	100	300	£104.90

**BOSS PIPE SINGLE 2" BSPT**

Product Code	Diameter (mm)	Price
TX4053	100	£116.02

**BOSS PIPE DOUBLE 2" BSPT OPPOSED**

Product Code	Diameter (mm)	Price
TX4054	100	£149.93

**BOSS PIPE DOUBLE 2" BSPT AT 90°**

Product Code	Diameter (mm)	Price
TX4055	100	£149.93

**STRAP ON BOSS 2" BSPT**

Product Code	Diameter (mm)	Price
TX4092	100 x 100	£95.52

**BLANK END**

Product Code	Diameter (mm)	Price
TX2051	50	£16.05
TX4051	100	£19.73

**BLANK END DRILLED & TAPPED 2" BSPT**

Product Code	Diameter (mm)	Price
TX4052	100	£42.86

**COWL**

Product Code	Diameter (mm)	Price
TX4056	100	£79.52

**PIPE TAPER**

Product Code	Diameter (mm)	Price
TX4046	100 x 50	£79.05

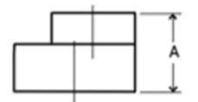
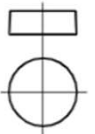
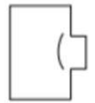
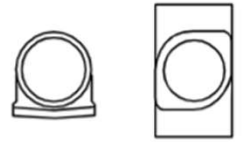

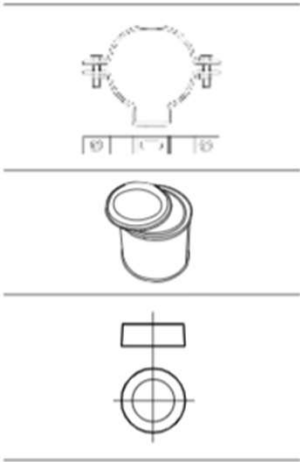

**COATED ADJUSTABLE BRACKETS**

Product Code	Diameter [mm]	Price
TX2067	50	£18.01
TX4067	100	£19.38

**GASKET LUBRICANT**

Product Code	Size	Price
TX0001	250ml Tube	£16.00

**GASKET RELAXING TOOL**

Product Code	Diameter [mm]	Price
TX0002	100	£26.67
TX0003	50	£26.67